

Captive Torx Button Head Screws

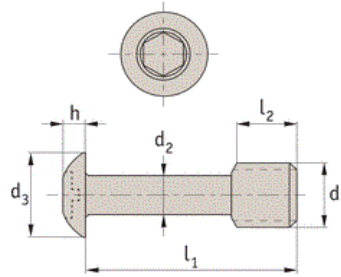

Screw The Captive Screw Through
The Screw Hole In The Cover
When The Screw Has Been
Removed From The Frame/Panel

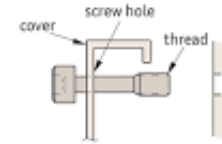

The Screw Will Not Fall From The
Cover Due To The Thread Catching
Against The Screw Hole In The
Cover.
Often Used With A Captive Washer

Captive Torx Button Head Screws						
Diameter-d1	M2.5	M3	M4	M5	M6	
d2 - (+/- 0.12)	1.7	2	2.8	3.7	4.2	
L2 - (+/- 0.25)	3.7	4.5	6	7.5	7.5	
d3 Max	5	5.6	8	9.5	12	
h Max	2.1	2.4	3.1	3.7	4.7	
h2	0.7	0.74	0.93	1.0	1.14	
Drive -TX	1	1	2	2	3	
	Lengths - L1 (+/- 1.5mm)					
	8	10	12	12	12	
	To	To	To	To	To	
	20	40	60	60	80	

Material: A2 Stainless Steel

INFORMATION AND DRAWINGS PROVIDED ARE FOR REFERENCE ONLY